



Date: July 9, 2026

To: Board of Directors

From: David Aranda, Interim General Manager (IGM)

Requested and Presented by: Director Jim Watt

Subject: Discussion Regarding Access Road from the Park to The School At 59 Arlington in Conjunction with Emergency Vehicle Needs, Handrails for Walking, Widening the Road and Proper Drainage for the Road

Recommendation

Due to the costly nature and degree of work that this request has, the board should provide direction to the IGM in how the majority of the board wishes to move forward.

Background

Director Watt has prepared the attached information and a brief overview of what he would like to see be improved upon for the access road.

The IGM has requested the two Chiefs to provide any thoughts they may have on this request. The IGM's comments and the two Chiefs' comments will be presented at the board meeting.

Exhibit(s)

- Improvements to Kensington Park Road

Improvements to Kensington Park Road

The KCSD owns Kensington Park Road (KPR) which extends from the Arlington to Kensington Hilltop school. KPR is gated from the community center to the school and intended for emergency use. KPR provides an alternate route for emergency vehicles, like fire engines, that could be blocked by heavy traffic on Highland Blvd. from parents trying to pick-up children.

KPR needs a water barrier on the south side to prevent further erosion and a 1 to 2 foot retaining wall on the north side to hold back the hillside and widen the road which narrows to 16 feet at some locations – 20 feet is preferred for two-way traffic. An existing drainage system needs to be better channeled to accept water coming down KPR. Improvements are needed to the pathway leading from KPR to the annex to include new steps and a railing to avoid accidents and liability issues. **A scope of work needs to be completed so bids can be obtained.**

The map below shows the route to the front of Kensington Hilltop school via Kensington Park





Gate at school to Kensington Park Rd.



Turn in road, needs hillside barrier



Erosion on south hillside
needs water barrier



Catch basin for road water
needs cleaning & hill barrier



Route to lower gate
16' to 18' wide
needs water and hill barriers

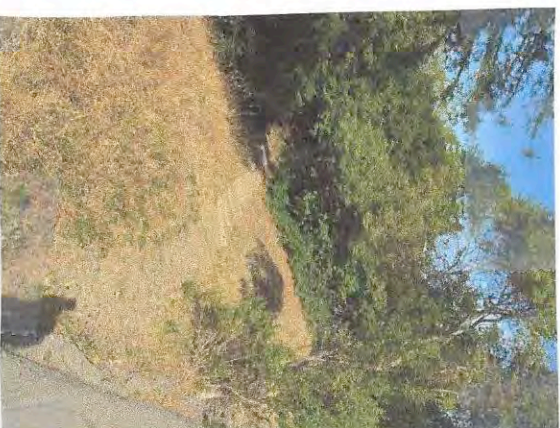

Footpath to lower road
needs improved steps and hand rail